

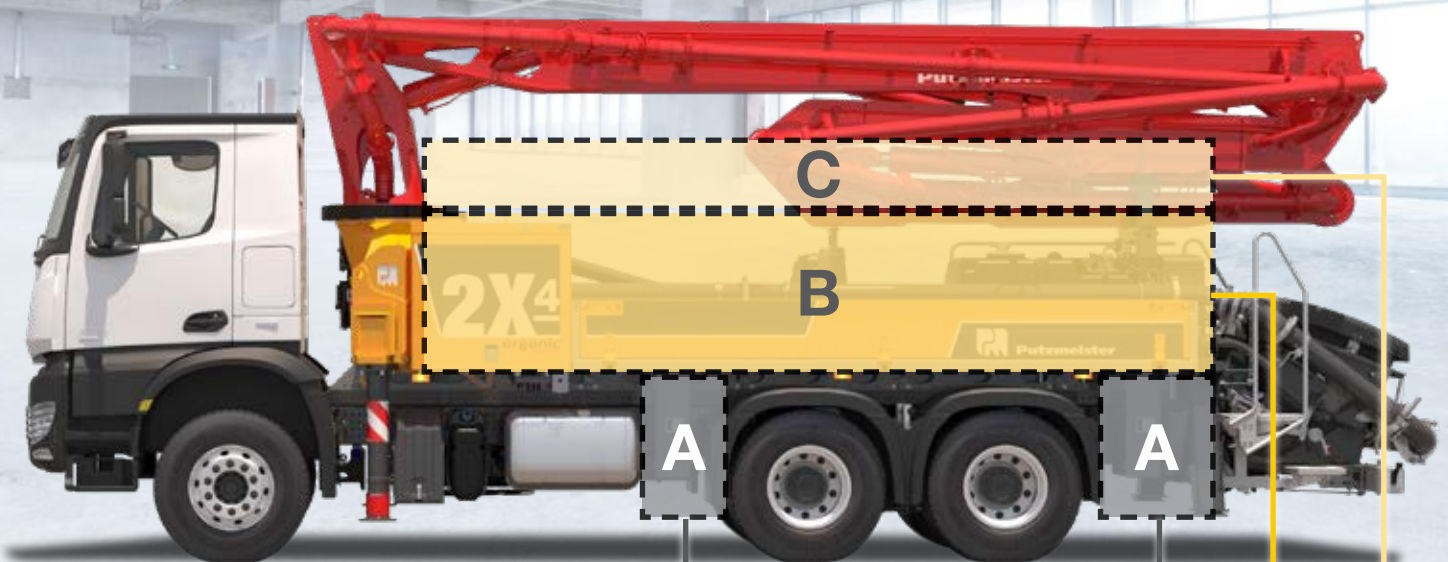

Putzmeister

The New BSF 2X Class Modular Storage Concept



Modular storage concept: The choice is yours!

High payload and ergonomic storage of pipes and hoses are key for every operator of a 20 meter class boom pump. The 20 m class offers more space than ever before for storage options, such as magazines, shelves or storage compartments for hoses, pipes, couplings and other accessories, as well as improved accessibility to these.

This is ensured by the 4.3 m continuous sidedeck, in combination with the modular storage concept. Depending on the machine configuration, this allows to transport more than 200 m of hoses and pipes!

On three different levels (A to C), the machine can be adapted to your personal needs – with the simple aim to make your daily hard work easier!

- Level A: Storage below the sidedeck
- Level B: Main storage room
- Level C: Additional storage room

**Configure storage space now
with your responsible sales
representative!**



SCAN ME

for more details
on YouTube

Numerous storage solutions form exactly your machine

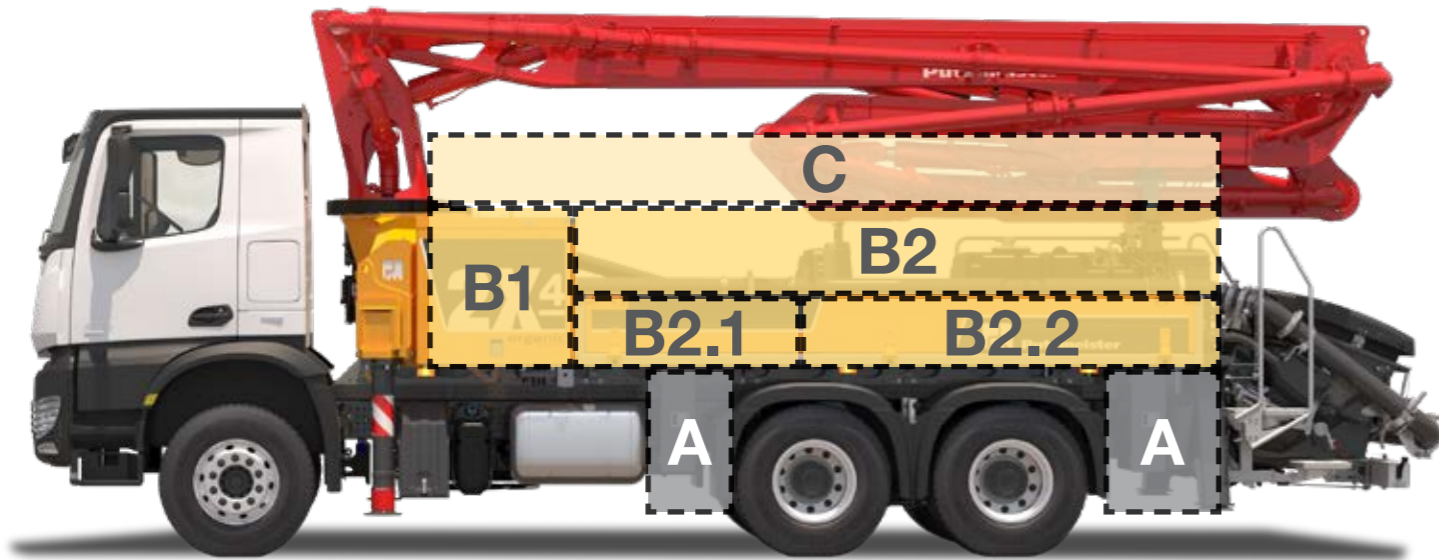

Overview

Exemplary for MB5600 with WB 3900

A Storage below sidedeck

Left side:

- Container for sponge balls
- Water hose reel for water pump
- Storage compartment
- Storage compartment, incl. 1 m reducing pipes
- Box for accessories, stainless steel

Right side:

- Compressor 455 l/min, 12 bar
- Compressor 930 l/min, 10 bar
- Water hose reel for high pressure water pump
- Spray tank with compressed air
- Storage compartment
- Box for accessories, stainless steel

B Main storage room

Left side:

- B1**
 - Toolbox with additional storage space
 - Additional 200 l water tank in the toolbox
- B2.1**
 - Storage compartment on sidedeck
 - Storage shelf for couplings, 1 m
 - Storage compartment and shelf for couplings
- B2.2**
 - Pipe storage compartment, 3 m

B2

- Side panels, foldable
- Magazine for hoses SK75, 4 m, fix
- Storage tray shelf, 4 m
- Ergonomic magazines, 4 m, hydr. retractable

Right side:

- B2.1**
 - Storage compartment on sidedeck
- B2.2**
 - Brackets for 10 pipes DN125, 3 m
- B2**
 - Side panels, foldable
 - Magazine for hoses SK75 plus storage boxes, 4 m, fix
 - Ergonomic magazines, 4 m, hydr. retractable

C Additional storage options

Left side:

- Storage boxes for accessories on top
- Storage tray, 5 m, slanted
- Storage tray, 4 m, straight

Right side:

- Storage boxes for accessories on top
- Storage tray, 5 m, slanted
- Storage tray, 4 m, straight

Details

A



Stowage compartment

ST003009

- Storage compartment for a tidy storage of all your equipment.
- Located under the sidedeck for optimal access to support plates and timber woods.
- Dimension can differ due to available mounting space.

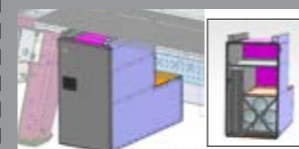

Stowage compartment incl. reducing pipes

ST003080 / ST003081

- The new storage compartment for a tidy storage of all your equipment.
- **Capacity for 2 pipes with 1 m length and DN125 and 2 pipes with 1 m length and DN100 (other diameters, other capacities), and other equipment.**



Box for accessories, stainless steel

ST002984 / ST002986

- Storage compartment for a tidy storage of all your equipment.
- Suitable for the storage of couplings or sponge balls
- Holes for drainage of water

B1



Toolbox with additional storage space

Standard

- As standard feature on every new 2X machine, we offer additional storage space inside of the toolbox
- This can be used for personal belongings or accessories (optional storage in additional tub).
- Furthermore, the toolbox comes with a high splash protection, which is also very important for working clothes and other belongings.



Additional 200 l water tank in the toolbox

RE002957

- Provides additional 200 l of water to the standard 700 l water capacity = **900 l of water for optimal working conditions with the new 2X machines**
- Including its own auxiliary water pump, which is switchable via a lever on the FFH
- Smart integration into the toolbox design
- This also puts the center of gravity more to the front of the machine and gives more weight reserves on the rear axle

B2



Side panels, foldable

EX003050

- Safe storage on the sidedeck thanks to foldable panels
- Dimensions can differ due to machine dimensions and configuration (400, 600 and 800 mm height available)
- Option remains if options on B2.1 or B2.2 are selected
- EX003172: 600 mm height
- EX003173: 800 mm height

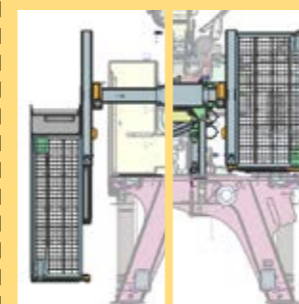

Ergonomic magazines, 4 m, hydr. retractable

ST003082 - ST003086

- Easy and ergonomic loading and unloading of hoses thanks to height-adjustable magazine
- Easy handling of magazine
- Reduced setup space needed thanks to new kinematics of the retractable magazine
- (Un)loading of hoses is possible from rear and the front
- Complete magazine can be dropped off and exchanged with another one
- Compact design of kinematics to retain the serviceability of the machine even equipped with magazines
- Optional: storage tray on top for even more equipment
- Left side: ST003082: up to 24 hoses with 4 m length and SK75 = up to 96 m overall
ST003083: up to 14 hoses with 4 m length and SK100 = up to 56 m overall
- Right side: ST003084: up to 28 hoses with 4 m length and SK80 = up to 112 m overall
ST003085: up to 21 hoses with 4 m length and SK100 = up to 84 m overall
ST003086: up to 24 hoses with 4 m length and SK80 & 100 = up to 96 m overall

These options are still available on a limited basis at the beginning. In any case, a hydraulic magazine will be available (e.g. of the last generation).



New fixed magazine for hoses

ST003087

- Tidy storage of hoses thanks to new Putzmeister magazine.
- Easy and ergonomic loading and unloading of hoses thanks to guide rollers
- Best distribution and compactness for as many hoses as possible with cost-efficient design
- Lightweight design with aluminum to be equipped within the road regulation
- Optional: storage tray on top for even more equipment
- **Capacity for up to 24 hoses with 4 m length and SK75 = up to 96 m overall (other diameters, other capacities)**



New magazine for hoses and storage boxes below

ST003088

- Lightweight design with PE-pipes
- Optional: storage tray on top for even more equipment
- Entry-level storage model with cost-conscious design
- Additional space for accessories with boxes below
- **Capacity for up to 16 hoses with 4 m length and SK75 = up to 64 m overall (other diameters, other capacities)**



Storage tray shelf

ST003089

- Combination of different levels of storage trays to give flexible storage space for hoses and pipes – no need to adopt the magazines or anything else.
- Flexible storage of different hose and pipe diameters and lengths up to 4 m overall.
- Easy storage of hoses thanks to simple design and flexible distribution of as many hoses as possible with cost-efficient design
- Safe storage thanks to clever design and optional tension belts
- **Capacity for up to 7 hoses with 4 m length and SK100 per level = up to ~100 m overall (other diameters, other capacities)**

Explaining the configuration logic:

It can be configured only one option per defined storage space of the levels B and C. Meaning: 1x B2.1 and 1x B2.2. But by choosing B2, B2.1 and B2.2 will be blocked. To configure level C you need to have B too.

B2.1

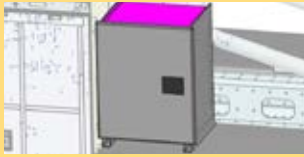

Storage compartment on sidedeck

ST003092, ST003093

- Storage compartment for a tidy storage of all your equipment.
- Located above the sidedeck for additional storage space of accessories.
- Furthermore, this space can be used for other equipment like operator clothing, sponge balls, couplings and more.
- Dimension of the storage compartment can differ due to available mounting space.



Storage shelf for couplings

ST003091

- Modular storage shelf for accessories like couplings and more.
- The basic frame is a rear wall with a perforated system, which enables you to adopt it to your specific needs.
- Choosing between holder for couplings, boxes, drawers and more to store your belongings and tools even more convenient.

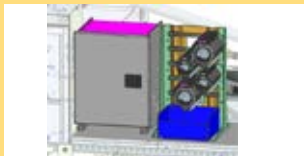

Storage compartment and shelf for couplings

ST004003

- Combination of stowage box and a smaller storage shelf for couplings to store support plates, timber woods and other accessories.
- Same advantages like on the single options

B2.2



Pipe storage compartment

ST003090

- Pipe rack with fixed uprights for 3 m pipes for easier (un)loading of the machine
- Tidy storage and secure loading of pipes thanks to new pipe compartment with holders to protect the pipes from falling out.
- Optional: storage tray on top for even more equipment
- **Capacity for up to 9 hoses with 3 m length and DN125 = up to 27 m overall** (other diameters, other capacities)



Pipe brackets

ST002981

- Most cost-efficient design with this pipe brackets for 3m pipes
- Easy storage of pipes thanks to bracket system
- Best distribution and compactness for as many pipes as possible with cost-efficient design
- Optional tension belts to securing the load within the brackets
- **Capacity for up to 10 hoses with 3 m length and DN125 = up to 30 m overall** (other diameters, other capacities)

C

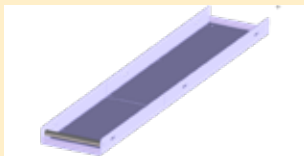

Storage tray

ST003094 – ST003097

- Easy storage of hoses thanks to storage trays
- Flexible distribution of as many hoses as possible with cost-efficient design
- Different versions available: for 4m or 5m hoses
- Optional tension belts to securing the load within the tray
- Additional Advantage: Easy and ergonomic access via hydr. retractable magazines
- **Capacity for hoses depending on different diameters but choosing between overall length between 4 or 5 m.**

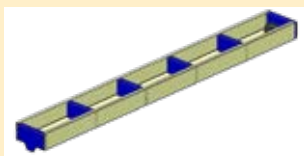

Storage boxes for accessories on top

ST003098, ST003099

- Additional storage space for other accessories like couplings etc.
- 5 m overall length
- *We recommend this option only for hydr. retractable magazines, because then the storage boxes can be easily reached on an ergonomic working height.*
- Using every part of the machine to put even more equipment on it!
- **Capacity for even more additional equipment like couplings, tools and more**

Putzmeister Concrete Pumps GmbH

Max-Eyth-Straße 10 · 72631 Aichtal

P.O.Box 2152 · 72629 Aichtal

Tel. +49 (7127) 599-0 · Fax +49 (7127) 599-520

pmw@putzmeister.com · www.putzmeister.com

